

型号(Type) : EMHSC3000LP

单颗电池规格 Specifications of single cell

Nominal voltage		1.2V	
Capacity		0.2C Discharge	10C Discharge
	Minimum	290min	5.0min
	Typical	308min	5.4min
Dimensions	Diameter	mm	
	Height	22.2(±0.3mm)	
		41.8(±0.5mm)	
Weight(Approximately)		gram	
		54.0	
Internal Impedance At 1000 Hz		6mΩ(Max) (After Charge)	
Charge	Standard	300mA(0.1C)×15hrs	
	Rapid	3000mA(1.0C)×1.05hrs	
Ambient temperature	Charge	standard	°C
			0°C to 45°C
	Rapid		0°C to 40°C
	Discharge		-20°C to 50°C
	Storage		-20°C to 40°C

Cell Size (Dimensions with tube) (mm)

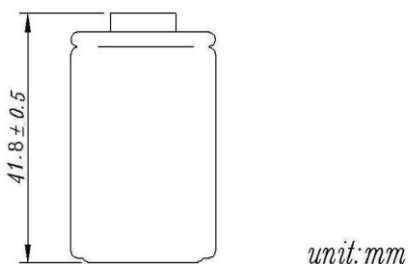
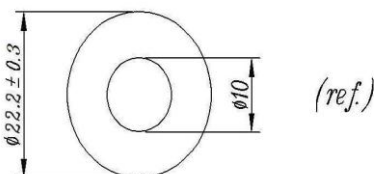

备注 Note:

- 公称容量は 20°C 环境下 0.2C 放电容量を指す。
Nominal capacity, rated at 0.2C 20°C.
- 容量は参考値とする
Average capacity, for reference only.
- 重量と内部抵抗は参考値とする
Weight and internal impedance are For reference.
- サイクル寿命は IEC 基準に基づいて算定する
Standard according as IEC of test cycle life。

Typical characteristics

Standard charge characteristics

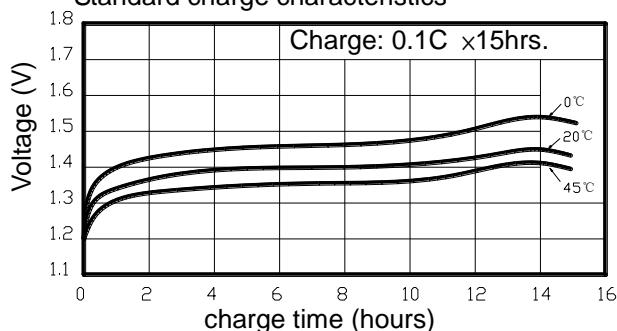

Rapid charge characteristics

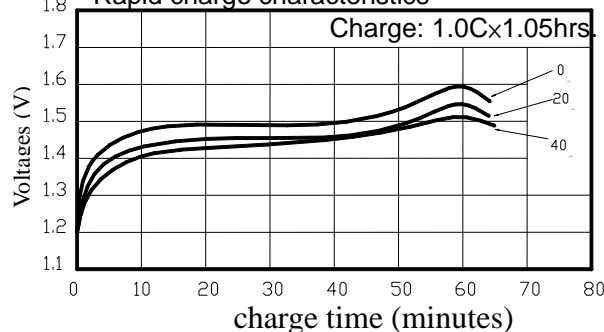

Discharge characteristics

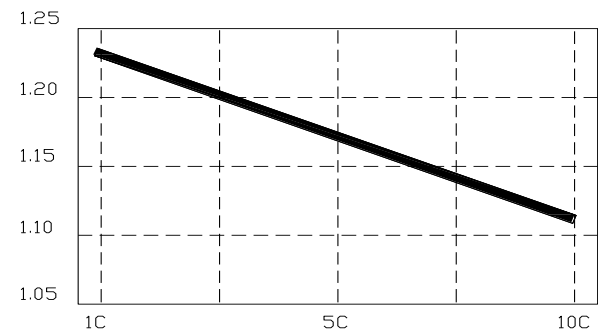
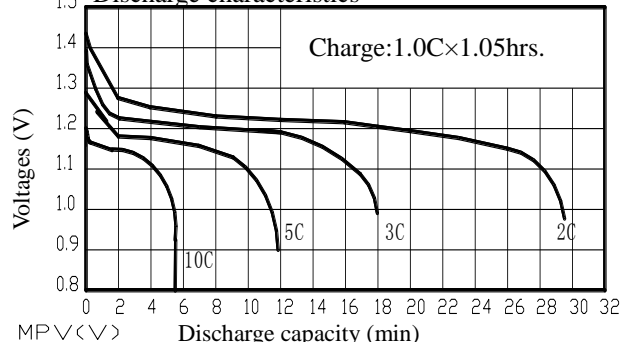

Charge retention curves of Ni-MH cylindrical cell At various storage temperature

